

PIPE(TUBE) CUTTER Of Best Technology

-Cutter Manual

 - TCA1.0)

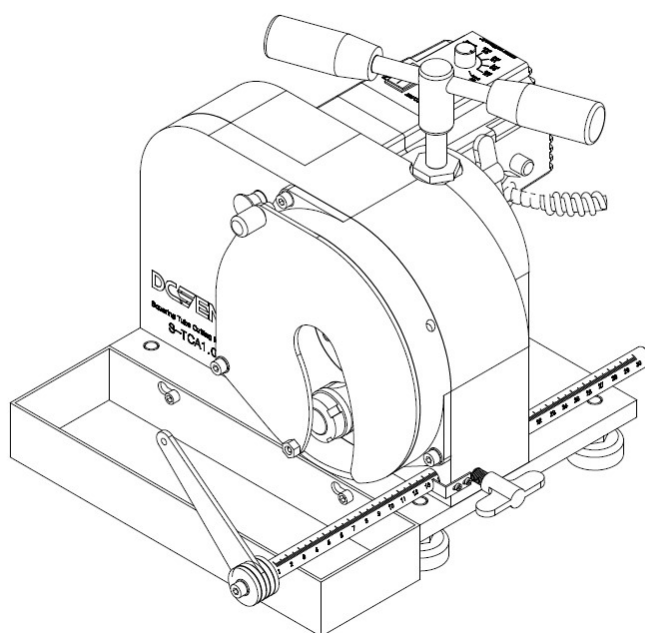

SAFETY PRECAUTIONS

Thanks for choosing the S-Cutter

Make sure that you carefully read and fully understand the Manual to use the device correctly and keep yourself and your properties safe.



CONTENTS

1. SAFETY PRECAUTIONS	03
2. Must-Follow Rules	06
3. Instruction Before Use	08
4. How to Use	10
5. Quality Warranty	18

SAFETY PRECAUTIONS



01 Keep the workplace clean and well-lit at all times.

An untidy or dark workplace may result in an accident.

Consider your work environment.

Do not let it wet.

02 Do not use in humid place.

Install bright lighting in the work place.

Do not use the machine near the flammable liquids or gases.

Keep yourself safe from electric shock.

03 Do not touch the grounded parts(i.e. water pipes, heaters, ranges, refrigerators).

Ensure the grounding wire is properly connected to the ground and use it.

Keep out any unauthorized persons.

04 Do not let the outsiders contact with tool or extension cord.

Do not let visitors access to the work area.

Keep the product safe.

05 Cut off the power when the tool is not in use, and keep it where it is not accessible to outsiders.

Do NOT operate at overload.

06 More efficient and safe operations are enabled within a permitted power range.

Always use the proper tools.

07 Use the standard parts and components provided by the head office.

Do not use the tool for purposes other than their intended use or in places away from the working range.

Dress properly.

08 Do not wear loose clothing or jewelry.

You may be hurt by the moving parts of the tool.

It is recommended to wear non-slip footwear for outdoor work.

Be sure to wear safety glasses and protective gloves.

09 Wearing safety gear such as goggles and gloves can reduce the risk of bodily injury.

Scattering chips can do serious damage to the eyes or cause a burn.



PIPE(TUBE) CUTTER Of Best Technology

- Do NOT abuse the cord.**
- 10 Do not drag the product by pulling the electric cord.
Do not unplug the cable by pulling the cord itself.
Keep the cord safe from heat, oil and sharp edges.
- 11 **Secure the workpiece.**
Secure the workpiece by using a lock.
- 12 **Pay attention to your work.**
Please note the fall and cut pipe pinch.
- Manage the product carefully.**
Keep the product clean and efficient for safe operation.
When replacing the management regulations and tools, comply with the
- 13 instructions.
Check plugs and wires regularly and contact experts to repair the damage.
Check connection cables regularly and replace damaged parts.
Keep the control board dry and avoid getting oil or grease.
- 14 **Remove from power source.**
When not in use, checked, or replaced, turn off the switch.
- Please check before operation.**
- 15 Make sure that the tool(insert tip) has been tightened.
Make sure that the pipe is tightened.
Make sure the 'Switch for size' is properly set according to the tube size
- Be careful of operating the machine accidentally.**
- 16 Do not carry when the power is connected.
When turning on, make sure that the operation switch is off.
- 17 **Electrical cable for connection outdoors.**
Use the authorized extension poser cord with a qualifying mark.
- Be cautious all the time.**
- 18 Observe work process and process accordingly.
Do not use this product if the concentration is blurred,
- Make sure that there is no damage on the product.**
Check the safety device and examine thoroughly that the mildly damaged parts now function normally before resuming the use of the tool.
- 19 Check if the product got stuck, or the parts are damaged.
The complete operation of the tool is not guaranteed unless all parts are normally assembled, and all requirements are met.
Unless otherwise stated in the Manual, the damaged safety device or parts should be repaired or replaced at the customer service center.

Caution!

- 20 For your safety, use the parts and tools indicated on the manual or recommended by the manufacturer.
Use of other parts or additional tools that are not recommended in the manual and catalog may occur accidents.

Repair request to the experts

- 21 The product meets the related safety regulations. For repair, contact an expert. Failure to do so may result in an accident.



Must-Follow Rules



- ➔ The instructions in this user manual contains information that is important to the safe use of this product.
Not following these instructions can cause death, serious injury, and massive property damage.
- ➔ For safety, the instructions are divided into 'WARNING' and 'CAUTION' depending on degree of risk, and the details are as follows:

Symbol		Description
	WARNING	※ There is a high possibility of serious injury or death when the instructions are violated.
	CAUTION	※ There is a possibility of serious injury or death when the instructions are violated. ※ There is a possibility of device failure or degradation when the instructions are violated.

- ➔ Precautions were recorded to prevent an accident that might easily occur while using or handling the product and execute operations safely.
The safety warnings and cautions cannot cover all conditions or situations that can take place during operation. Therefore, remain focused during operation or storing. Read and fully understand the Manual to prevent an accident.
- ➔ **Special safety precautions**
'WARNING' or 'CAUTION' mark makes a user stay alert because there is a possibility of hazards under particular conditions.

Additional safety warnings

- ➔  Read all safety warnings and all instructions.
-  Wear safety goggles.
-  Wear safety gloves.

 **WARNING**

- **Make sure the power is connected to the ground.**
Leakage current due to electric shock may occur if the product is not connected to the grounding.
- **Do NOT pour cutting fluid or water.**
Due to the water or other liquids on the electric motor, electric shock or death may occur.
- **Do NOT work the machine in wet conditions or rain.**
An electric shock may result in serious bodily injury or death.
- **Avoid fingers, hands or clothes to touch the tip while operating.**
If your finger, hand or any part of your body is caught in the tool, serious bodily injury may occur.
- **Keep your finger, hand or any part of your body away from the rotating device.**
If your finger, hand or any part of your body stuck in the machine, it may occur serious injury.
- **Before supplying power to the product, be sure to turn off the operation switch.**
Plugging in with the switch on may cause sudden rotation and occur serious injury.
- **Keep any part of your body away from the pressing or rotating unit.**
Failure to do so may result in serious injury.
- **Make sure to wear safety equipment.**
Chips generated during the operation may scatter and cause serious eye or other body part injury.

 **CAUTION**

- **Use the tools and parts provided by the Company for the originally intended purposes.**
In the case it is not available to use the tools and parts proved by us, use only products certified for their quality(nationally certified or higher).
Any violation of this provision may result in serious injury or product degradation.
- **Do NOT leave the product rotated.**
Workers may result in bodily injury.
- **Adjust the direction of scattering chips for safety.**
If chips land on a flammable material, a fire can break out. If it touches human skin, it may result in a burn.
- **Wear gloves and long-sleeve clothes.**
Scattering chips can cause burns.
- **Use extension cord as short as possible.**
If it is too long or too thin, it may cause overload.
- **Test run the product prior to operation.**
This ensures safer operations by checking if the tool functions normally without problems.



Instruction Before Use



1. Check the electric leakage breaker

Make sure the system is powered on the circuit breaker is installed.

Check if an electric leakage breaker(ELB) with rated capacity is installed in all electric units.

Make sure that the ground wire is connected to the powered system.

2. Extension power cord

If an electrical outlet is not nearby, use an extension power cord.

Choose a proper one in terms of length and thickness, considering the flow of electricity. If it is too long or thin, voltage increases, causing overload.

Use a short power cord as much as possible.

* Specification of the extension cord has to be at least $1.0\text{mm}^2 \times 3C$ (250V-10A).



If an electric power cord is damaged, it must be repaired or replaced with a new one immediately.

3. Check the power supply

Check the power supply stated on the nameplate and use the proper power source.

4. Check the switch off



If you insert the plug unaware the switch is turned on, it may result in serious accidents due to a sudden rotation of the product.

- TCA1.0

Squaring Tube Cutting Machine

High-quality cutting with auto control by size

One-touch operation regardless of size

Capacity: 1/4 - 1inch





How to Use

How to Use S-TCA1.0

Instructions before Use

Fully understand how to use the tool as instructed by the company or distributor. If you did not receive the required training, ask for training from those who already completed the training.

Make sure to remove the power when changing the insert tip.

Be sure to use consumables for this equipment that are provided by us.

Make sure to connect the grounding, and confirm the voltage.

Make sure to wear protective equipment such as protective glasses before work.

Beware of burns by tip and cutting tools which are extremely hot after operation.

Beware of burns by motor in case of prolonged use.

INDEX

01. Name of the parts and controls
02. Accessories
03. How to set the machine
04. How to mount the insert tip
05. How to set and cut the tube
06. Maintenance and inspection
07. Product specifications

1. Name of the parts and controls

- Name of the functional parts

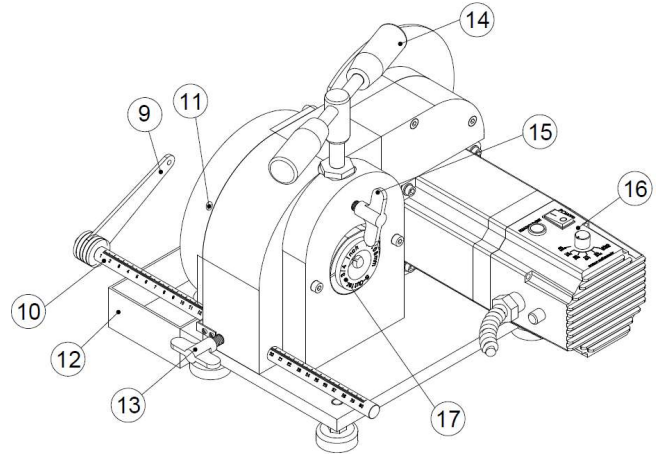
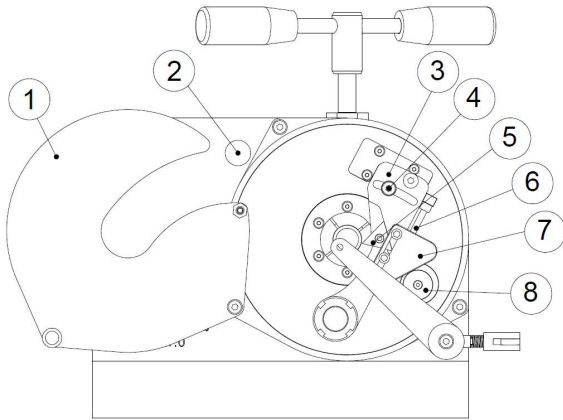

NO	Name	Function
1	Safety cover	Prevention of chip scattering
2	Origin setting button	Make size adjustment plate and cam parallel
3	Tool holder	Tool holder for mounting insert tip
4	Tool holder guide bolt	Pre-load bolt of tool holder guide
5	Insert tip	Tube cutting tool
6	Size adjustment bolt	Bolt for size adjustment plate
7	Size adjustment plate	Insert tip position adjustment
8	Cam adjustment handle	Manually adjusting the cam position
9	Stopper	Set a position to a desired length of a tube to be cut
10	Scale bar	Enable you to do precise and repetitive work by marking the scale
11	Size adjustment hole	Hole for hex-wrench
12	Chip box	Box for chip
13	Scale bar fixing bolt	Bolt for fixing the scale bar
14	Main collet clamping handle	Handle for main collet clamping
15	Main collet fixing bolt	Bolt for fixing the handle position
16	Motor control part	Motor control
17	Tube collet	Collet for size



PIPE(TUBE) CUTTER Of Best Technology

● Name of the control panel

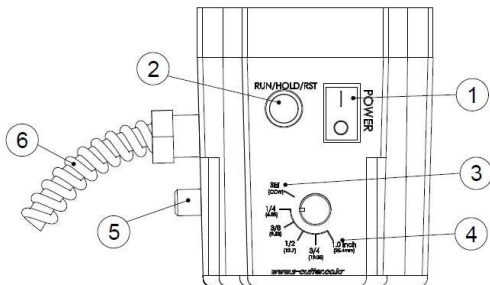

NO	Name	Function
1	Power switch	ON/OFF
2	RUN/HOLD/RST switch	Run / Hold / Reset Status indication lamp
3	SET	Set the starting position value
4	Switch for size	Choosing the tube size (1/4, 3/8, 1/2, 3/4, 1inch)
5	Fuse	5Ø-20mm, 250V-8A
6	Power cable	Power supply cable

2. Accessories



● Standard Accessories

Tube collet : 1/4, 3/8, 1/2, 3/4, 1inch

T-star wrench: T15-133mm(L)

T-hex wrench: 3mm-133mm(L)

● Optional Accessory

Insert tip : Including tip box, 10EA/BOX

3. How to set the machine

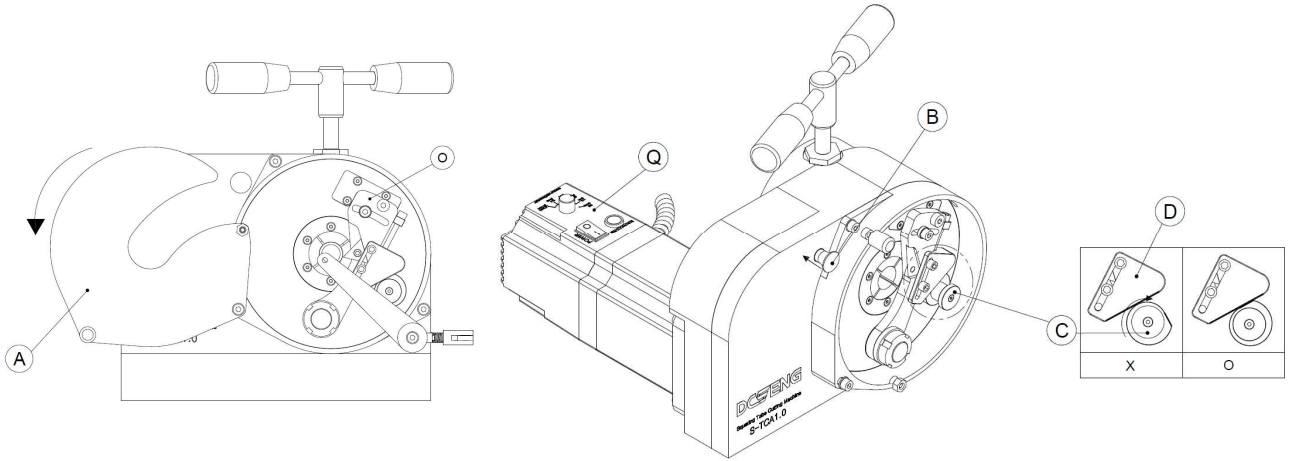

[Figure 1]

[Figure 2]

[Figure 3]

- 1) Open the safety cover(A) and check the inclined surface of the cam and the size adjustment plate(D) is well fit. [Figure 3]
- 2) If the inclined surface doesn't fit like [Figure 3], push the origin setting button(B) strongly and turn the cam adjustment handle(C) to make it parallel. [Figure 2, 3]
- 3) Change the mode as a 'SET' in the control panel(Q) and then press the 'RUN' switch to decide the position of the tool holder(O).
- 4) When the alarm on while working, set the machine with a process of 1) ~ 3) and use it.

4. How to mount the insert tip

- 1) Loosen the bolt(E) to place the insert tip(F) in the mounting position and use a T-star wrench to tighten it. [Figure 4]

* When installing the insert tip(F), check the groove before tightening it.

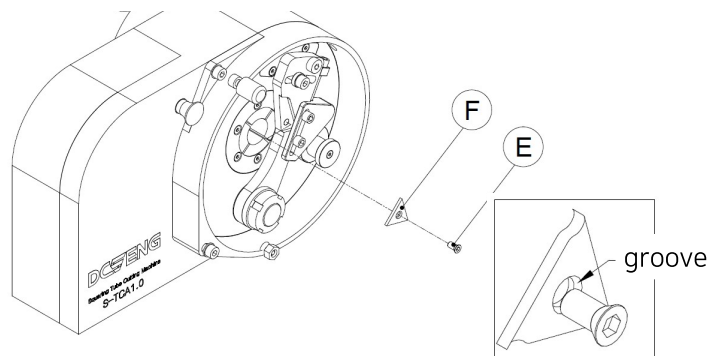

[Figure 4]



5. How to set and cut the tube

- 1) Install the tube collet(I) which fits with the tube size to be cut in line with the bolt seat of the main collet mounting part(G). [Figure 5]

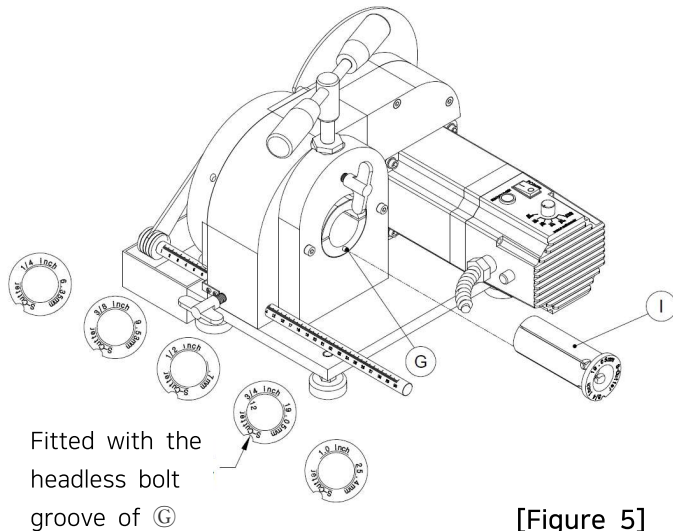

[Figure 5]

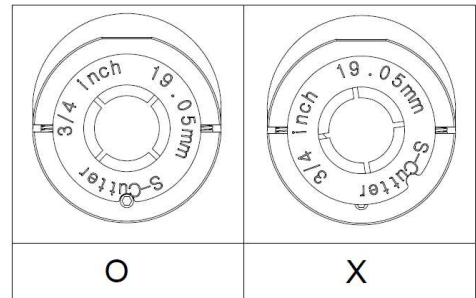

- 2) Loosen the size adjustment plate fixing bolt and put the T-hex wrench into the size adjustment hole(P) to adjust the size adjustment plate bolt(M) to position the insert tip(F) close to the tube(about 0.5mm). [Figure 6, 7]

- * When loosening the size adjustment bolt(M): The insert tip(F) gets closer to the tube.
- * When tightening the size adjustment bolt(M): The insert tip(F) gets farther away from the tube.

- 3) Firmly tighten the size adjustment plate fixing bolt(L).

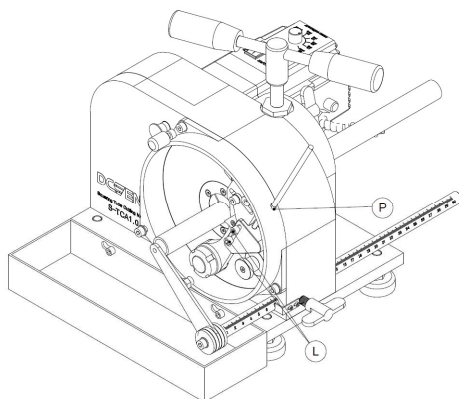

[Figure 6]

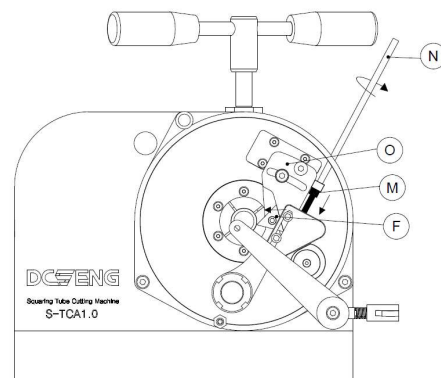

[Figure 7]

4) After checking the length with the scale bar(J), tighten the scale bar fixing bolt(K) and main collet clamping handle(H) to fix it and then close the safety cover(A). [Figure 8, 9]

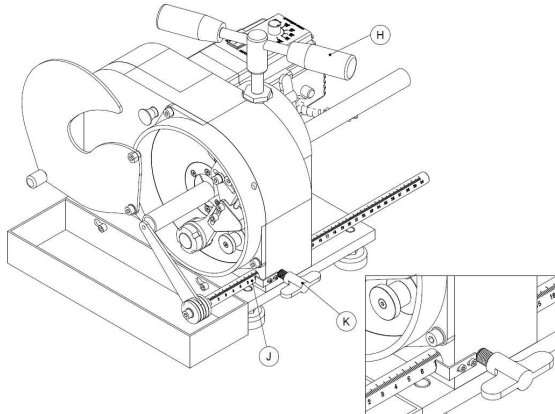

[Figure 8]

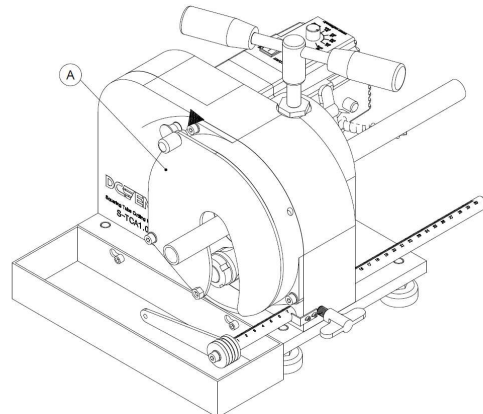

[Figure 9]

5) Turn on the power switch(①) of control panel(Q) and set the switch for size(②) according to the tube size to be cut, and press RUN/HOLD/RST switch(③) to start cutting(since it returns to the place where it is first set, it is possible to continuously work on it). [Figure 10]

*** RUN/HOLD/RST**

- Press the switch to operate the machine. It automatically stops when working is done(one-touch and one cycle method)
- If you press the switch while operating, it stops, and if you press the switch again, the machine restarts and it automatically stops when working is done.
- When the alarm is sent out for reasons such as overload while working, solve the problem of the alert and release the alarm by pressing the switch(at the start of the work after the alarm occurs, the machine must be set. [Ref) 3. How to set the machine])

* If the cutting chip is piled up, disassemble the chip box(R) in the direction of the arrow and disposal of it. [Figure 11]

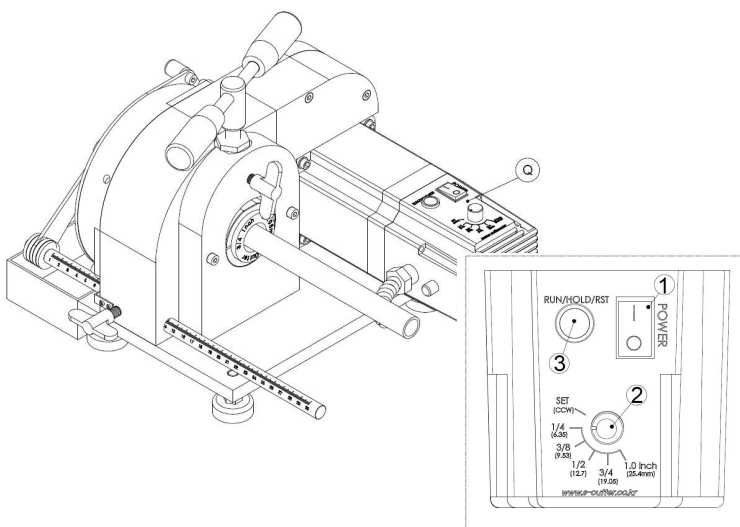

[Figure 10]

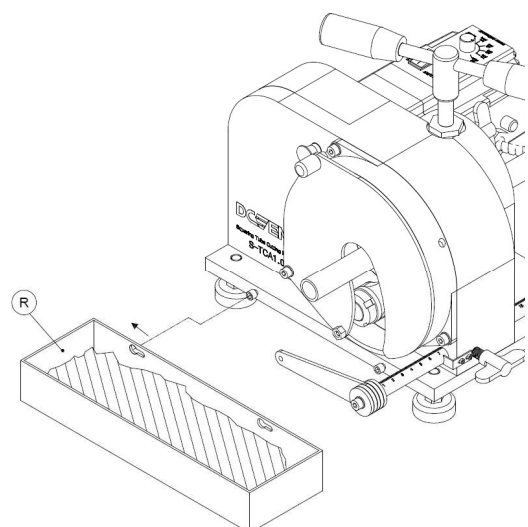

[Figure 11]



6. Maintenance and Inspection

- Make sure that the power cord is unplugged before repair or maintenance.

A. Inspection of the screw device for each part

- Fasten any loose screws tightly. It is very dangerous to use the tool with loose screws.

B. Inspection of tube collet and main collet clamping handle

- It is an important part of fixing the tube so, check the tube collet and main collet clamping handle regularly.
- It is very dangerous to use the machine without fixing the tube.

C. Inspection of handling for the major operation part

- Some scattering chips could be entered during operation.

D. Work place and storing after work

- It is recommended that workplace would be indoor where it is not humid and has to temperature difference between daytime and nighttime.
- Keep in a dry place after the operation, to prevent access to the children and outsiders.
- Do not use vinyl or cloth during long-term storage and store it in a dedicated case.

E. Alarm transmission and fuse replacement

- If the alarm is sent out due to overload and electric shock during operation
 - When the LED lamp at the control panel is blinking, push the reset switch or off the power switch for more than a few tens of seconds to reset.
- Replace the fuse(8A) which is attached at the side of the motor(Ø5 - 20mm).

F. When the machine does not operate properly

- It is very dangerous for consumers to find or repair the fault area, so please contact the nearest after-sales service center or distributors.

7. Product specifications

● Machine Specification

Description		Specification
Cutting capacity	Capacity	1/4, 3/8, 1/2, 3/4, 1inch (6.35, 9.53, 12.7, 19.05, 25.4mm)
	Thickness	Maximum 2.0mm
Technical data	Size	Tool case(300*250*250)
	Weight	14.5kg

- The design and specifications of the product are dated on March 2021.
- They are subject to change without notice for the purpose of product improvement.
- Make sure that you carefully read and fully understand the manual and safety instruction before use.

● Motor Specification

Description	Unit	Cutting motor
Rated output	W	200
Rated voltage	V	AC 200 - 220V / 50 - 60Hz
Rated current	A	0.8
Operating Environment	-	-20°C - 40°C / 20 - 80%RH

- The design and specifications of the product are dated on March 2021.
- They are subject to change without notice for the purpose of product improvement.
- Make sure that you carefully read and fully understand the manual and safety instruction before use.

Quality Warranty



It guarantees as below.

1. This product have passed the thorough quality inspection of DCSENG CO., LTD.
2. When the product is damaged in a normal operation, the product will be repaired free of charge for one year in the purchasing place or service center in accordance with the contents of this certificate.
3. But the return delivery fee will be charged. Malfunction of the product after the warranty period completed or occurred by customer's carelessness, can be repaired or replaced at a minimum cost.
4. However, malfunction due to change of use, abnormal wear, using parts from other companies, or repair in other A/S center may not be covered by the warranty certificate.
5. Repair cost will be charged in these cases;
 - Damage caused by the negligence of the user
 - Failure caused by not following precautions outlined in this product
 - Failure due to unreasonable repair and renovation.
 - Breakdown of electric motor
 ※ Since the warranty of electric motor is provided by the manufacturing company of installed product, it is not included in the quality assurance of our company.
6. The warranty certificate must be accompanies when repairing.
7. This certificate is not reissued.

Product name	S-Cutter	Warranty Period	One year from purchase date
Model No.	S-TCA1.0	Purchase Date	20 / / /
Serial Number		Date of Manufacture	20 / / /
Customer Address		Name	
		Mobile No.	
Distributor Address (Company name)		Name	

※ Blanks should be filled by seller or customer when the product is being sold.

DCSENG DCSENG CO., LTD.
<http://www.s-cutter.co.kr>

23-22, Jukjeon-3gil, Hyeondo-myeon, Seowon-gu, Cheongju-si,
 Chungcheongbuk-do, 28214, Republic of Korea
 TEL : +82-43-256-0945 / FAX : +82-43-256-0946
 E-mail : sales@dcseng.co.kr

PIPE(TUBE) CUTTER Of Best Technology



DCSENG CO., LTD.
23-22, Jukjeon-3gil, Hyeondo-myeon, Seowon-gu,
Choengju-si, Chungcheongbuk-do, Republic of Korea
T. 043)256-0945 F. 043)256-0946
W. www.dcseng.co.kr www.s-cutter.co.kr